

AIREYE MAINTENANCE

Please take a few moments each year to perform the following preventive maintenance inspection on your fan to ensure its safe and efficient operation.

- ☑ **Clean the fan.** Remove the front cage to access the fan blade assembly. Dust the blades, cage, and motor. If desired, use a gentle cleaner or degreasing agent.

If necessary, the fan can be rinsed during cleaning. Make sure to disconnect the fan from power, remove the occupancy sensor (AEOS), and disconnect controller from motor cable. **Do not expose controller or AEOS to water.**

- ☑ **Inspect the upper safety cable for fraying or damage.** The cable should be wrapped tightly around the building structure, leaving as little slack as possible. The shackle should be securely tightened and located on the topside of the structure.
- ☑ **Inspect all fasteners, the mounting system, and the fan assembly for signs of corrosion, cracking, or fatigue/severe wear.** Replace if needed.
- ☑ **Make sure all plugs are fully seated and the cord retainers are properly installed.**
- ☑ **If ion generators are installed, inspect each ion generator for dust accumulation or damage.** Use a soft, dry cloth or compressed air to remove dust or debris.
- ☑ **Make sure all mounting bolts and nuts are present and torqued according to the table below.**
- ☑ **Make sure the set screws securing the blade assembly to the motor are torqued according to the table below and that the blade assembly retainer is secure.**

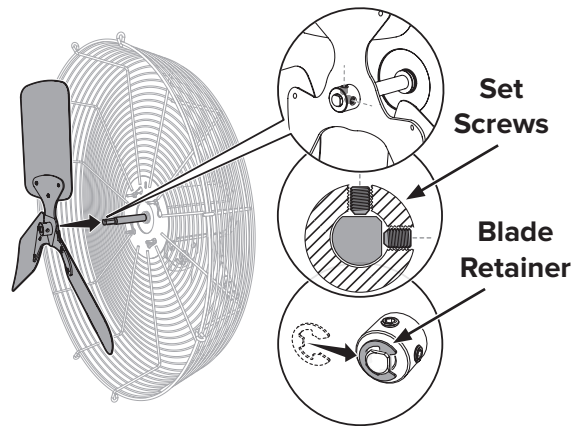
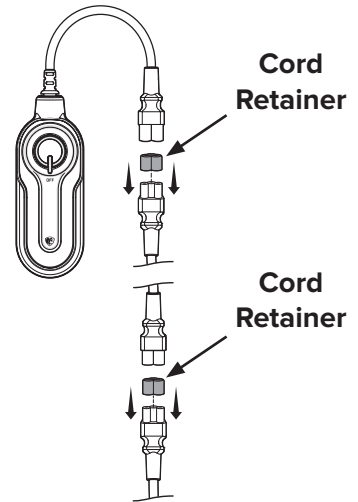

Mount/Part	Hardware	Torque
All Mounts	1/2-13 Main Mounting Bolt	30 ft·lb
All Mounts	1/4-20 Angle Adjustment Bolt	7 ft·lb
Swivel	(4) 1/2-13 x 3.5" Hex Head Cap Screws	30 ft·lb
C-Channel	(8) 3/8-16 Hex Nuts	20 ft·lb
I-Beam	(8) 3/8-16 Hex Nuts	20 ft·lb
Wall	7/16-14 x 4" Hex Head Cap Screw	30 ft·lb
Blade Assembly	(2) Allen Head Set Screws	20 ft·lb
Rear Guard	(4) Flange Nuts	2.5 ft·lb

⚠ WARNING: Risk of fire, electric shock, or injury to persons during cleaning and user maintenance! Disconnect the appliance from the power supply before servicing.

⚠ WARNING: When service or replacement of a component in the fan requires the removal or disconnection of a safety device, the safety device is to be reinstalled or remounted as previously installed.